

2A0

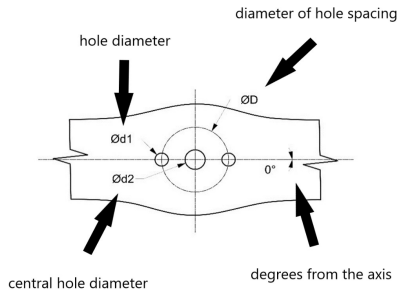
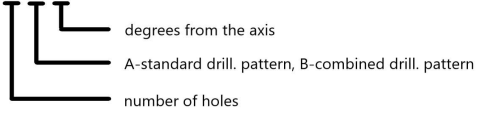

types

Standard drilling patterns

2A0

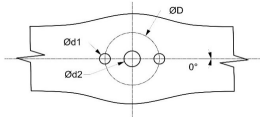

Ød1 =
Ød2 =
ØD =



2A90

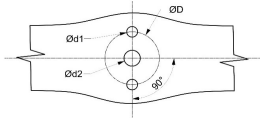

Ød1 =
Ød2 =
ØD =



4A0

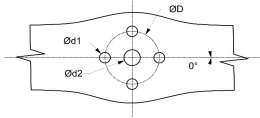

Ød1 =
Ød2 =
ØD =



4A45

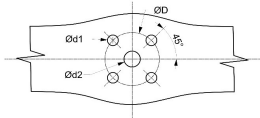

Ød1 =
Ød2 =
ØD =



6A0

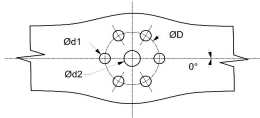

Ød1 =
Ød2 =
ØD =



6A30

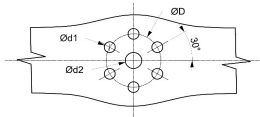

Ød1 =
Ød2 =
ØD =



types

Combined drilling patterns

2A0+2B90

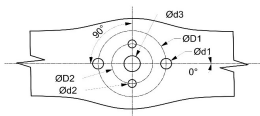

Ød1 =
ØD1 =
Ød2 =
ØD2 =
Ød3 =

